



### Zone Sentry® Zone Valve

The Taco Zone Sentry® Zone Valve enhances the overall performance of any zone valve system. The unique patented technology in the Zone Sentry® utilizes a microcircuit based logic to control a gear driven electronic actuator which drives a ball valve based body design. All this adds up to a zone valve that leads the industry in energy efficiency, flow capacity ( $C_v$ ), shutoff pressure rating, ease of installation, diagnostic capability and the number of valves (12) that can be use on a standard 40VA transformer.



# Submittal Data Information Zone Sentry® Ball Valve Zone Valve

Submittal Data # 101-140

Supersedes: 10/01/10

Effective: 10/20/10

## Product Specifications

Max. Operating Pressure.....	300 PSI (2100 kPa)
Max. Shutoff Pressure .....	125 PSI (875 kPa)
Fluid Temperature Range.....	20-240°F (7°-115°C)
Service.....	Water or Water/Glycol up to 50% Glycol Close Systems (Open System — Option Available)
Ball Rotation Speed .....	(90° turn), Approximately (after charge time)
Electrical Rating.....	24 VAC, 60Hz 0.48 Amps
Power Consumption.....	11.4 W, 0.48 Amps (Charging)
Power Consumption.....	1.44W, 0.06 Amps (Power On)
Heat Anticipator Setting.....	0.5 Amps
End Switch Rating.....	1 Amp @ 24 VAC

## Materials of Construction, Actuator:

Body .....	High Performance Engineered Polymer
Gears .....	High Performance Internally Lubricated Engineered Polymer

## Materials of Construction, Valve:

Body .....	Forged Brass
Stem .....	Brass
Press Ring .....	Brass
Ball .....	Brass (Chrome Plated)
Seat .....	Modified Teflon®
O-Rings .....	EPDM

## Application:

Taco Zone Sentry® Zone Valves provide on-off, normally open or normally closed control in both open and closed hydronic systems. The valves can be used in a wide variety of heating and cooling applications, primarily designed for use with baseboard, fan coils, radiators, convectors, air handlers, heat pumps and radiant applications.

## Ease of Installation / Operation:

The Taco Zone Sentry® is the most technologically advanced zone valve ever made. It's also simple to install and operate. The valve can be installed in any direction, in any orientation. We then went a step further, allowing the operator to be mounted to the valve body in either direction, great for those tight baseboard jobs. Snap-in quick connects on the back of the valve make for a simple, secure and fast wiring hook-up. A green LED light shows full functionality of the valve's operation and thermostat status. Under a no power situation the manual override button located on the top of the valve allows the ball to be rotated up to 90° and is also marked with a slot to indicate the position of the valve.

Typical Zone Sentry Zone Valve Wiring:

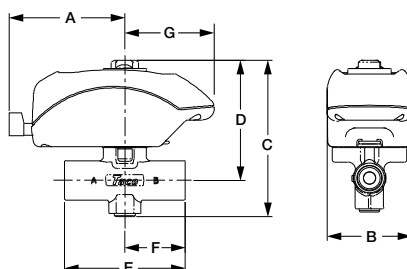
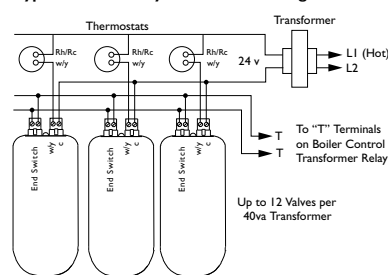

Valve Size	Cv (Kv) / Ft. of Pipe Equiv.**	Close-Off Pressure (kPa)
1/2"	4.9 (4.3) / 9.5	0-125 psi (0-862 kPa)
3/4"	10.3 (8.9) / 8.4	0-125 psi (0-862 kPa)
1"	8.9 (7.7) / 47.4	0-125 psi (0-862 kPa)

\*\*At 4' per second  
(Maximum recommended residential flow rate).

## Zone Sentry® Dimensions: (FOR REFERENCE PURPOSES)

Valve Size	A		B		C		D		E (Sweat)		E (Threaded)		F		G		Weight (Valve + Actuator)	
	in.	mm	in.	mm	in.	mm	in.	mm	in.	mm	in.	mm	in.	mm	in.	mm	Lbs.	Kg
1/2"	3"	76.2	2.375"	60.3	4.125"	104.7	2.06"	52.3	3.125"	79.3	4.750"	120.6	1.562"	39.7	2.312"	58.7	0.85	0.385
3/4"	3"	76.2	2.375"	60.3	4.125"	104.7	2.12"	53.8	3.125"	79.3	3.312"	84.1	1.562"	39.7	2.312"	58.7	0.90	0.408
1"	3"	76.2	2.375"	60.3	4.125"	104.7	2.12"	53.8	3.875"	98.4	3.875"	98.4	1.875"	47.6	2.312"	58.7	1.10	0.498



Taco Inc., 1160 Cranston Street, Cranston, RI 02920 / (401) 942-8000 / Fax (401) 942-2360  
Taco (Canada) Ltd., 8450 Lawson Road, Unit #3, Milton, Ontario L9T 0J8 / (905) 564-9422 / Fax (905) 564-9436  
[www.taco-hvac.com](http://www.taco-hvac.com)