

# Product comparison guide

SE7000 Series room controllers



Control



Performance



Energy savings

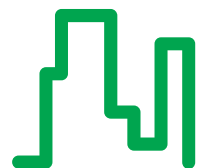

Better building  
management

Schneider Electric SE7000 Series room controllers bridge the gap between stand-alone sensors and intelligent building management systems, delivering simplified automation and communications to a broad range of mid-market opportunities.

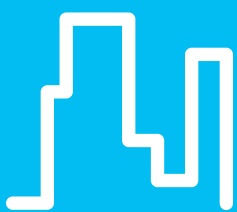

Commercial



Retail



Healthcare

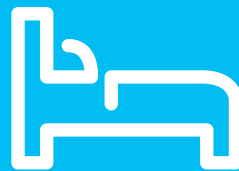

Hotels



Education



# Introducing simplified building management

Schneider Electric introduces the new SE7000 Series room controllers, delivering advanced climate control at an affordable price for mid-market applications. The SE7000 Series offers a variety of application-specific products to increase the comfort of building occupants while reducing energy costs and consumption and accelerating return on investment. The digital controllers give users easy-to-install, thermostat-like functionality that can sense occupancy and adjust set-point or fan speed control. From roof top to fan coil, to terminal unit and heat pump applications, you'll be in full control.

# Table of contents

## Digital stand-alone and communicating room controllers

|                           |         |
|---------------------------|---------|
| SE7200 .....              | 8       |
| SE7300 .....              | 9       |
| SE7305 .....              | 10      |
| SE7300-ECM .....          | 12      |
| SER7300 and SCs .....     | 13      |
| SE7600A and SE7600B ..... | 14 - 15 |
| SE7600H .....             | 17      |
| SE7600E .....             | 17      |
| SE7600F .....             | 18      |
| SE7600W .....             | 19      |
| SE7682S .....             | 20      |
| SEZ7000 .....             | 21      |

## Wireless accessories and specifications

|                                |    |
|--------------------------------|----|
| Wireless integration .....     | 22 |
| Wireless gateway .....         | 22 |
| Wireless serial adapters ..... | 23 |
| Wireless accessories .....     | 23 |
| Wireless specs .....           | 24 |

## Accessories and specifications

|                            |    |
|----------------------------|----|
| Covers .....               | 25 |
| Remote sensors .....       | 25 |
| Communication boards ..... | 25 |
| Specs .....                | 26 |
| Remote sensor specs .....  | 26 |

Not all products in the catalogue may be available in every country,  
please check availability with the local Schneider Electric office.





# Comfortable workers are more productive.

Accelerate your return on investment with  
SE7000 Series room controllers.



# Cost-saving, energy-saving applications

From hotels and hospitals to schools, retail, and commercial buildings, Schneider Electric offers wide-ranging room control solutions for your building management needs. Whether retrofitting current systems with a more technologically advanced room controller or going green with a more environmentally friendly option, SE7000 Series is the ideal, cost-competitive solution. The SE7000 Series room controllers can be equipped with an integrated passive infrared motion sensor for demand-based occupancy control that opens up new opportunities in smart energy management.

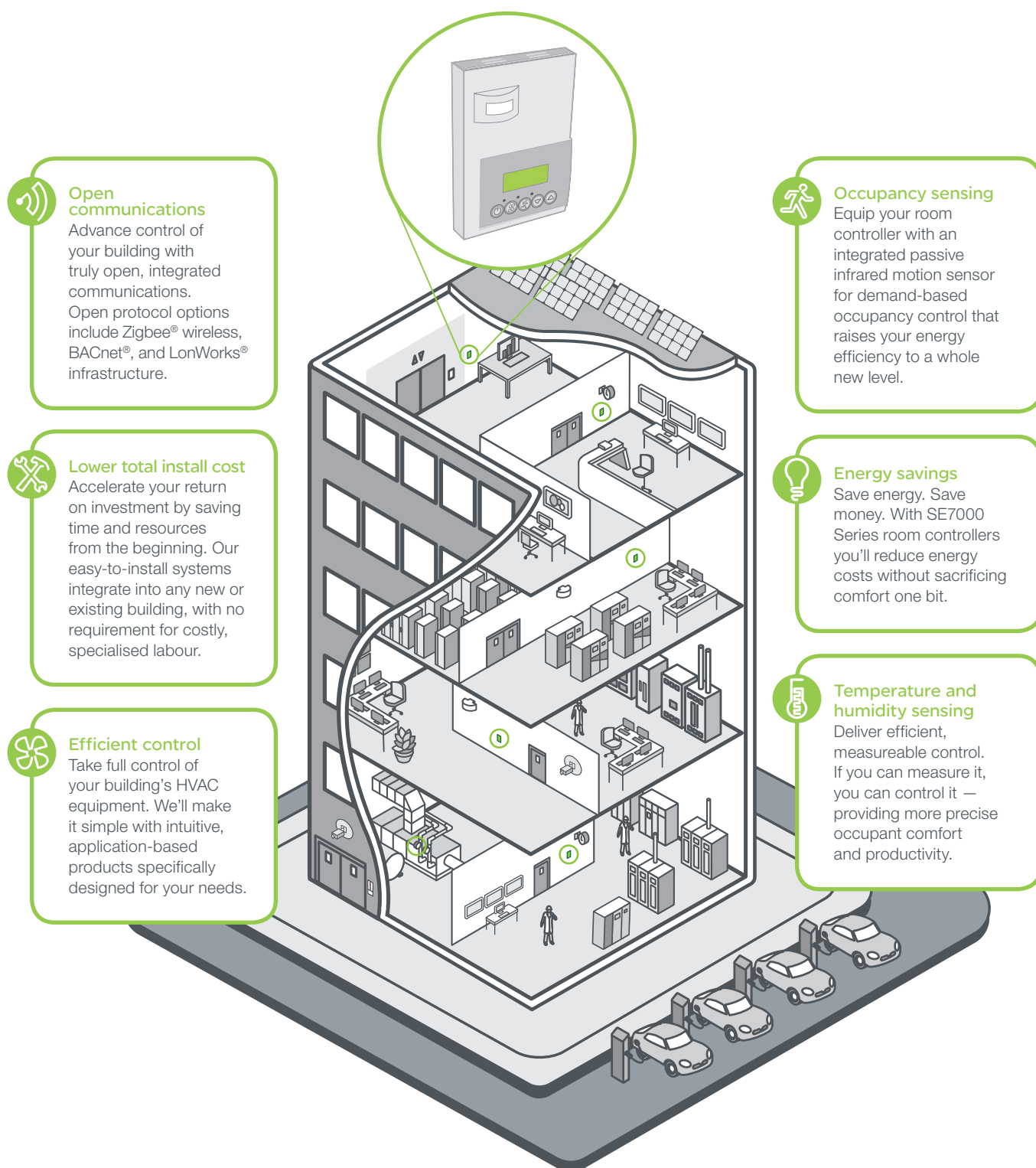

## Digital stand-alone and communicating room controllers

Schneider Electric offers three room controller models to meet your specific application-based needs. All models feature an intuitive user interface with a backlit LCD display and configurable system and fan functions for optimal control in any application. For zoning applications, the SE7200 Series includes local hydronic reheat valve control and pressure dependent VAV (with or without local reheat). The SE7300 Series is specifically designed for fan coil control. Models are available with on/off, three-point floating, or analogue outputs. The SE7600 Series can be installed in any building using a standard roof top or heat pump unit with a requirement for advanced control.



| SE7200 Series  | SE7300 Series   | SE7600 Series   |
|--|---|---|
| <b>Zoning, heating/cooling</b>   | <b>Fan coil, three-speed fan</b>  | <b>Roof top or heat pump</b>  |
| <ul style="list-style-type: none"> <li>• Reheat control</li> <li>• Induction units</li> <li>• Chilled beam</li> <li>• Under floor heating</li> <li>• Perimeter radiant heat</li> <li>• Pressure dependent VAV</li> </ul> | <ul style="list-style-type: none"> <li>• Two pipe</li> <li>• Four pipe</li> </ul> | <ul style="list-style-type: none"> <li>• Economiser option</li> <li>• Humidification/dehumidification heat pumps</li> <li>• Roof top, 3 heat/2 cool</li> <li>• Water source with dehumidification, 1 heat/2 cool</li> </ul> |

## SE7200 | Zone controllers

Smart energy management has never been easier with SE7200 Series room controllers, designed specifically to control on/off, floating, or heating or cooling terminal equipment such as pressure dependent VAVs, valves, or other end devices. Ideal for both new construction and retrofit projects, the controllers decrease project delivery costs by reducing installation, configuration, and commissioning time.



| Part Number  | Description                 | Output             | PIR Cover | Communication               |
|--------------|-----------------------------|--------------------|-----------|-----------------------------|
| SE7200C5045  | Stand-alone zone controller | Floating or on/off | No        | Stand-alone (network ready) |
| SE7200C5045B | BACnet zone controller      | Floating or on/off | No        | BACnet                      |
| SE7200C5045E | LON zone controller         | Floating or on/off | No        | LonWorks                    |
| SE7200C5045W | Wireless zone controller    | Floating or on/off | No        | Wireless                    |
| SE7200C5545  | Stand-alone zone controller | Floating or on/off | Yes       | Stand-alone (network ready) |
| SE7200C5545B | BACnet zone controller      | Floating or on/off | Yes       | BACnet                      |
| SE7200C5545E | LON zone controller         | Floating or on/off | Yes       | LonWorks                    |
| SE7200C5545W | Wireless zone controller    | Floating or on/off | Yes       | Wireless                    |
| SE7200F5045  | Stand-alone zone controller | 0 - 10 V           | No        | Stand-alone (network ready) |
| SE7200F5045B | BACnet zone controller      | 0 - 10 V           | No        | BACnet                      |
| SE7200F5045E | LON zone controller         | 0 - 10 V           | No        | LonWorks                    |
| SE7200F5045W | Wireless zone controller    | 0 - 10 V           | No        | Wireless                    |
| SE7200F5545  | Stand-alone zone controller | 0 - 10 V           | Yes       | Stand-alone (network ready) |
| SE7200F5545B | BACnet zone controller      | 0 - 10 V           | Yes       | BACnet                      |
| SE7200F5545E | LON zone controller         | 0 - 10 V           | Yes       | LonWorks                    |
| SE7200F5545W | Wireless zone controller    | 0 - 10 V           | Yes       | Wireless                    |

### SE7200 Series ordering

# SE7200

# 45

#### Control output type:

- C = Floating or on/off digital control outputs
- F = Analogue 0 - 10 VDC control outputs

#### PIR options:

- 50 = PIR ready but PIR cover not included
- 55 = Factory assembled with PIR cover

#### Communication options:

- B = BACnet® MS/TP
- E = Echelon®
- W = Zigbee® wireless
- = Network ready

#### Example:

##### SE7200F5045B

- Zone Control
- Analogue 0 - 10 VDC outputs
- PIR ready
- Schneider Electric branded
- BACnet communications

\* Some part number configurations may not be available. Please refer to the tables for available versions.



## SE7300 | Fan coil room controllers

Achieve better energy efficiency and reduce operating costs with SE7300 Series room controllers. Ideal for commercial and hotel applications, these fan coil units function with electronically commutated motors to optimise fan control sequences. With the full proportional operating of the SE7300, as opposed to the traditional three-speed tap operation, customers will experience better control and a more comfortable environment.

### Commercial interface (local override)



| Part Number  | Description                     | Humidity | Output             | PIR Cover | Communication               |
|--------------|---------------------------------|----------|--------------------|-----------|-----------------------------|
| SE7300C5045  | Stand-alone fan coil controller | No       | Floating or on/off | No        | Stand-alone (network ready) |
| SE7300C5045B | BACnet fan coil controller      | No       | Floating or on/off | No        | BACnet                      |
| SE7300C5045E | LON fan coil controller         | No       | Floating or on/off | No        | LonWorks                    |
| SE7300C5045W | Wireless fan coil controller    | No       | Floating or on/off | No        | Wireless                    |
| SE7300C5545  | Stand-alone fan coil controller | No       | Floating or on/off | Yes       | Stand-alone (network ready) |
| SE7300C5545B | BACnet fan coil controller      | No       | Floating or on/off | Yes       | BACnet                      |
| SE7300C5545E | LON fan coil controller         | No       | Floating or on/off | Yes       | LonWorks                    |
| SE7300C5545W | Wireless fan coil controller    | No       | Floating or on/off | Yes       | Wireless                    |
| SE7300F5045  | Stand-alone fan coil controller | No       | 0 - 10 V           | No        | Stand-alone (network ready) |
| SE7300F5045B | BACnet fan coil controller      | No       | 0 - 10 V           | No        | BACnet                      |
| SE7300F5045E | LON fan coil controller         | No       | 0 - 10 V           | No        | LonWorks                    |
| SE7300F5045W | Wireless fan coil controller    | No       | 0 - 10 V           | No        | Wireless                    |
| SE7300F5545  | Stand-alone fan coil controller | No       | 0 - 10 V           | Yes       | Stand-alone (network ready) |
| SE7300F5545B | BACnet fan coil controller      | No       | 0 - 10 V           | Yes       | BACnet                      |
| SE7300F5545E | LON fan coil controller         | No       | 0 - 10 V           | Yes       | LonWorks                    |
| SE7300F5545W | Wireless fan coil controller    | No       | 0 - 10 V           | Yes       | Wireless                    |
| SE7350C5045  | Stand-alone fan coil controller | Yes      | Floating or on/off | No        | Stand-alone (network ready) |
| SE7350C5045B | BACnet fan coil controller      | Yes      | Floating or on/off | No        | BACnet                      |
| SE7350C5045E | LON fan coil controller         | Yes      | Floating or on/off | No        | LonWorks                    |
| SE7350C5045W | Wireless fan coil controller    | Yes      | Floating or on/off | No        | Wireless                    |
| SE7350C5545  | Stand-alone fan coil controller | Yes      | Floating or on/off | Yes       | Stand-alone (network ready) |
| SE7350C5545B | BACnet fan coil controller      | Yes      | Floating or on/off | Yes       | BACnet                      |
| SE7350C5545E | LON fan coil controller         | Yes      | Floating or on/off | Yes       | LonWorks                    |
| SE7350C5545W | Wireless fan coil controller    | Yes      | Floating or on/off | Yes       | Wireless                    |
| SE7350F5045  | Stand-alone fan coil controller | Yes      | 0 - 10 V           | No        | Stand-alone (network ready) |
| SE7350F5045B | BACnet fan coil controller      | Yes      | 0 - 10 V           | No        | BACnet                      |
| SE7350F5045E | LON fan coil controller         | Yes      | 0 - 10 V           | No        | LonWorks                    |
| SE7350F5045W | Wireless fan coil controller    | Yes      | 0 - 10 V           | No        | Wireless                    |
| SE7350F5545  | Stand-alone fan coil controller | Yes      | 0 - 10 V           | Yes       | Stand-alone (network ready) |
| SE7350F5545B | BACnet fan coil controller      | Yes      | 0 - 10 V           | Yes       | BACnet                      |
| SE7350F5545E | LON fan coil controller         | Yes      | 0 - 10 V           | Yes       | LonWorks                    |
| SE7350F5545W | Wireless fan coil controller    | Yes      | 0 - 10 V           | Yes       | Wireless                    |

## SE7305 | Fan coil room controllers

Hotel/lodging interface (°C/°F selection)



| Part Number  | Description                     | Humidity | Output             | PIR Cover | Communication               |
|--------------|---------------------------------|----------|--------------------|-----------|-----------------------------|
| SE7305C5045  | Stand-alone fan coil controller | No       | Floating or on/off | No        | Stand-alone (network ready) |
| SE7305C5045B | BACnet fan coil controller      | No       | Floating or on/off | No        | BACnet                      |
| SE7305C5045E | LON fan coil controller         | No       | Floating or on/off | No        | LonWorks                    |
| SE7305C5045W | Wireless fan coil controller    | No       | Floating or on/off | No        | Wireless                    |
| SE7305C5545  | Stand-alone fan coil controller | No       | Floating or on/off | Yes       | Stand-alone (network ready) |
| SE7305C5545B | BACnet fan coil controller      | No       | Floating or on/off | Yes       | BACnet                      |
| SE7305C5545E | LON fan coil controller         | No       | Floating or on/off | Yes       | LonWorks                    |
| SE7305C5545W | Wireless fan coil controller    | No       | Floating or on/off | Yes       | Wireless                    |
| SE7305F5045  | Stand-alone fan coil controller | No       | 0 - 10 V           | No        | Stand-alone (network ready) |
| SE7305F5045B | BACnet fan coil controller      | No       | 0 - 10 V           | No        | BACnet                      |
| SE7305F5045E | LON fan coil controller         | No       | 0 - 10 V           | No        | LonWorks                    |
| SE7305F5045W | Wireless fan coil controller    | No       | 0 - 10 V           | No        | Wireless                    |
| SE7305F5545  | Stand-alone fan coil controller | No       | 0 - 10 V           | Yes       | Stand-alone (network ready) |
| SE7305F5545B | BACnet fan coil controller      | No       | 0 - 10 V           | Yes       | BACnet                      |
| SE7305F5545E | LON fan coil controller         | No       | 0 - 10 V           | Yes       | LonWorks                    |
| SE7305F5545W | Wireless fan coil controller    | No       | 0 - 10 V           | Yes       | Wireless                    |
| SE7355C5045  | Stand-alone fan coil controller | Yes      | Floating or on/off | No        | Stand-alone (network ready) |
| SE7355C5045B | BACnet fan coil controller      | Yes      | Floating or on/off | No        | BACnet                      |
| SE7355C5045E | LON fan coil controller         | Yes      | Floating or on/off | No        | LonWorks                    |
| SE7355C5045W | Wireless fan coil controller    | Yes      | Floating or on/off | No        | Wireless                    |
| SE7355C5545  | Stand-alone fan coil controller | Yes      | Floating or on/off | Yes       | Stand-alone (network ready) |
| SE7355C5545B | BACnet fan coil controller      | Yes      | Floating or on/off | Yes       | BACnet                      |
| SE7355C5545E | LON fan coil controller         | Yes      | Floating or on/off | Yes       | LonWorks                    |
| SE7355C5545W | Wireless fan coil controller    | Yes      | Floating or on/off | Yes       | Wireless                    |
| SE7355F5045  | Stand-alone fan coil controller | Yes      | 0 - 10 V           | No        | Stand-alone (network ready) |
| SE7355F5045B | BACnet fan coil controller      | Yes      | 0 - 10 V           | No        | BACnet                      |
| SE7355F5045E | LON fan coil controller         | Yes      | 0 - 10 V           | No        | LonWorks                    |
| SE7355F5045W | Wireless fan coil controller    | Yes      | 0 - 10 V           | No        | Wireless                    |
| SE7355F5545  | Stand-alone fan coil controller | Yes      | 0 - 10 V           | Yes       | Stand-alone (network ready) |
| SE7355F5545B | BACnet fan coil controller      | Yes      | 0 - 10 V           | Yes       | BACnet                      |
| SE7355F5545E | LON fan coil controller         | Yes      | 0 - 10 V           | Yes       | LonWorks                    |
| SE7355F5545W | Wireless fan coil controller    | Yes      | 0 - 10 V           | Yes       | Wireless                    |

### SE7300 Series ordering

SE73                   45      

#### Humidity sensor and control:

- 0 = No humidity sensor
- 5 = Internal humidity sensor

#### PIR options:

- 50 = PIR ready but PIR cover not included
- 55 = Factory assembled with PIR cover

- ECM = For fan coil applications that have ECM motors

#### Example:

##### SE7355C5545B

- Fan coil
- Internal humidity sensor
- Hospitality
- Floating control
- Factory installed PIR cover
- Schneider Electric branded
- LON communications

#### Compatibility:

- C = Floating or on/off digital control outputs
- F = Analogue 0 - 10 VDC control outputs

#### Control key function:

- 0 = Override, for commercial applications
- 5 = °C/°F, for hotels/lodging applications

#### Communication options:

- B = BACnet® MS/TP
- E = Echelon®
- W = Zigbee® wireless
- = Network ready

\* Some part number configurations may not be available. Please refer to the tables for available versions.



# Check in to comfort. Check out the savings.

Hotel guest comfort meets energy savings  
with SE7000 Series room controllers.





## SE7300-ECM | ECM fan coil controllers - Coming soon!

More and more engineers are commonly specifying fan coil units that function with electronically commutated motors, which offer better energy efficiency and reduced operating costs. The SE7300 ECM fan coil controller allows you to capitalise on this additional energy savings by optimising fan control sequences of electronically commutated motors. The controller is optimised to offer full proportional operation versus the traditional three-speed tap operation. This wall-mounted controller features an easy-to-read digital display and built-in commissioning and configuration utility, temperature sensor and optional humidity and passive infrared occupancy sensor (PIR) cover.

### Commercial interface (local override)



| Part Number      | Description                         | PIR Cover | Communication               |
|------------------|-------------------------------------|-----------|-----------------------------|
| SE7300F5045-ECM  | Stand-alone ECM fan coil controller | No        | Stand-alone (network ready) |
| SE7300F5045B-ECM | BACnet ECM fan coil controller      | No        | BACnet                      |
| SE7300F5045W-ECM | Wireless ECM fan coil controller    | No        | Wireless                    |
| SE7300F5545-ECM  | Stand-alone ECM fan coil controller | Yes       | Stand-alone (network ready) |
| SE7300F5545B-ECM | BACnet ECM fan coil controller      | Yes       | BACnet                      |
| SE7300F5545W-ECM | Wireless ECM fan coil controller    | Yes       | Wireless                    |

### Hotel/lodging interface (°C/°F selection)



| Part Number      | Description                         | PIR Cover | Communication               |
|------------------|-------------------------------------|-----------|-----------------------------|
| SE7305F5045-ECM  | Stand-alone ECM fan coil controller | No        | Stand-alone (network ready) |
| SE7305F5045B-ECM | BACnet ECM fan coil controller      | No        | BACnet                      |
| SE7305F5045W-ECM | Wireless ECM fan coil controller    | No        | Wireless                    |
| SE7305F5545-ECM  | Stand-alone ECM fan coil controller | Yes       | Stand-alone (network ready) |
| SE7305F5545B-ECM | BACnet ECM fan coil controller      | Yes       | BACnet                      |
| SE7305F5545W-ECM | Wireless ECM fan coil controller    | Yes       | Wireless                    |

## SER7300 Series ordering

**SER73**   **A**   **45**

#### Humidity sensor and control:

- 0 = No humidity sensor
- 5 = Internal humidity sensor

#### PIR options:

- 50 = PIR ready but PIR cover not included
- 55 = Factory assembled with PIR cover

#### Communication options:

- B = BACnet® MS/TP
- W = Zigbee® wireless
- = Network ready

#### Example:

#### SER7305A5545B

- Line Voltage Fan Coil controller
- Internal Humidity Sensor
- Hotel/Lodging application, °C/°F
- Factory assembled with PIR cover
- BACnet® MS/TP communication

#### Control key function:

- 0 = Override, for commercial applications
- 5 = °C/°F, for hotels/lodging applications

\* Some part number configurations may not be available. Please refer to the tables for available versions.

## SER7300 and SCs | Fan coil terminal equipment controllers - Coming soon!

This new cost-effective solution for upgrading line-voltage fan coil unit thermostats requires only two components: the SER7300 terminal equipment controller and the SC3000 relay pack. This solution allows existing line voltage wiring between the fan coil unit and temperature controller to be re-used, reducing overall costs and installation time. The SC3000 relay pack features an onboard universal voltage power supply and line-voltage relays which directly drive fractional horsepower fan motors and valves. This eliminates the need to install and wire costly pilot relays and transformers.

### Commercial interface (local override)



| Part Number   | Description  | Humidity | PIR Cover | Communication               |
|---------------|--|----------|-----------|-----------------------------|
| SER7300A5045  | Stand-alone fan coil terminal equipment controller | No       | No        | Stand-alone (network ready) |
| SER7300A5045B | BACnet fancoil terminal equipment controller       | No       | No        | BACnet                      |
| SER7300A5045W | Wireless fan coil terminal equipment controller    | No       | No        | Wireless                    |
| SER7300A5545  | Stand-alone fan coil terminal equipment controller | No       | Yes       | Stand-alone (network ready) |
| SER7300A5545B | BACnet fan coil terminal equipment controller      | No       | Yes       | BACnet                      |
| SER7300A5545W | Wireless fan coil terminal equipment controller    | No       | Yes       | Wireless                    |
| SER7350A5045  | Stand-alone fan coil terminal equipment controller | Yes      | No        | Stand-alone (network ready) |
| SER7350A5045B | BACnet fancoil terminal equipment controller       | Yes      | No        | BACnet                      |
| SER7350A5045W | Wireless fan coil terminal equipment controller    | Yes      | No        | Wireless                    |
| SER7350A5545  | Stand-alone fan coil terminal equipment controller | Yes      | Yes       | Stand-alone (network ready) |
| SER7350A5545B | BACnet fan coil terminal equipment controller      | Yes      | Yes       | BACnet                      |
| SER7350A5545W | Wireless fan coil terminal equipment controller    | Yes      | Yes       | Wireless                    |

### Hotel/lodging interface (°C/°F selection)



| Part Number   | Description  | Humidity | PIR Cover | Communication               |
|---------------|--|----------|-----------|-----------------------------|
| SER7305A5045  | Stand-alone fan coil terminal equipment controller | No       | No        | Stand-alone (network ready) |
| SER7305A5045B | BACnet fancoil terminal equipment controller       | No       | No        | BACnet                      |
| SER7305A5045W | Wireless fan coil terminal equipment controller    | No       | No        | Wireless                    |
| SER7305A5545  | Stand-alone fan coil terminal equipment controller | No       | Yes       | Stand-alone (network ready) |
| SER7305A5545B | BACnet fan coil terminal equipment controller      | No       | Yes       | BACnet                      |
| SER7305A5545W | Wireless fan coil terminal equipment controller    | No       | Yes       | Wireless                    |
| SER7355A5045  | Stand-alone fan coil terminal equipment controller | Yes      | No        | Stand-alone (network ready) |
| SER7355A5045B | BACnet fancoil terminal equipment controller       | Yes      | No        | BACnet                      |
| SER7355A5045W | Wireless fan coil terminal equipment controller    | Yes      | No        | Wireless                    |
| SER7355A5545  | Stand-alone fan coil terminal equipment controller | Yes      | Yes       | Stand-alone (network ready) |
| SER7355A5545B | BACnet fan coil terminal equipment controller      | Yes      | Yes       | BACnet                      |
| SER7355A5545W | Wireless fan coil terminal equipment controller    | Yes      | Yes       | Wireless                    |

### Transformer relay packs for fan coil units



| Part Number | Description  |
|-------------|--|
| SC3300E5045 | Transformer relay pack five relay outputs  |
| SC3400E5045 | Transformer relay pack five relay outputs, and four inputs                       |
| SC3404E5045 | Transformer relay pack five relay outputs, smart VDC OCC output, and four inputs |
| SC3500E5045 | Transformer relay pack four relay outputs and smart VDC output                   |
| SC3504E5045 | Transformer relay pack four relay outputs, smart VDC output, and four inputs     |
| SC3514E5045 | Transformer relay pack three slave fan outputs                                   |

### Wireless accessories for SER7300 Series



| Part Number   | Description            |
|---------------|------------------------|
| VWA5000D5045W | Wireless door switch   |
| VWA5000W5045W | Wireless window switch |



## SE7600A and SE7600B | Roof top controllers

Primarily designed for use in small to mid-sized commercial building applications, SE7600 Series room controllers can be installed in any building using a standard roof top or heat pump unit with a requirement for advanced fresh air control. Capable of controlling economiser-free cooling and demand-based ventilation strategies, the SE7600 Series provides fresh air measurement input right out of the box.



| Part Number  | Description                     | Scheduling | Economiser | Heat/Cool Stages | Humidity | PIR Cover | Communication               |
|--------------|---------------------------------|------------|------------|------------------|----------|-----------|-----------------------------|
| SE7600A5045  | Stand-alone roof top controller | No         | No         | 1H/1C            | No       | No        | Stand-alone (network ready) |
| SE7600A5045B | BACnet roof top controller      | No         | No         | 1H/1C            | No       | No        | BACnet                      |
| SE7600A5045E | LON roof top controller         | No         | No         | 1H/1C            | No       | No        | LonWorks                    |
| SE7600A5045W | Wireless roof top controller    | No         | No         | 1H/1C            | No       | No        | Wireless                    |
| SE7600A5545  | Stand-alone roof top controller | No         | No         | 1H/1C            | No       | Yes       | Stand-alone (network ready) |
| SE7600A5545B | BACnet roof top controller      | No         | No         | 1H/1C            | No       | Yes       | BACnet                      |
| SE7600A5545E | LON roof top controller         | No         | No         | 1H/1C            | No       | Yes       | LonWorks                    |
| SE7600A5545W | Wireless roof top controller    | No         | No         | 1H/1C            | No       | Yes       | Wireless                    |
| SE7600B5045  | Stand-alone roof top controller | No         | No         | 2H/2C            | No       | No        | Stand-alone (network ready) |
| SE7600B5045B | BACnet roof top controller      | No         | No         | 2H/2C            | No       | No        | BACnet                      |
| SE7600B5045E | LON roof top controller         | No         | No         | 2H/2C            | No       | No        | LonWorks                    |
| SE7600B5045W | Wireless roof top controller    | No         | No         | 2H/2C            | No       | No        | Wireless                    |
| SE7600B5545  | Stand-alone roof top controller | No         | No         | 2H/2C            | No       | Yes       | Stand-alone (network ready) |
| SE7600B5545B | BACnet roof top controller      | No         | No         | 2H/2C            | No       | Yes       | BACnet                      |
| SE7600B5545E | LON roof top controller         | No         | No         | 2H/2C            | No       | Yes       | LonWorks                    |
| SE7600B5545W | Wireless roof top controller    | No         | No         | 2H/2C            | No       | Yes       | Wireless                    |
| SE7605B5045  | Stand-alone roof top controller | No         | Yes        | 2H/2C            | No       | No        | Stand-alone (network ready) |
| SE7605B5045B | BACnet roof top controller      | No         | Yes        | 2H/2C            | No       | No        | BACnet                      |
| SE7605B5045E | LON roof top controller         | No         | Yes        | 2H/2C            | No       | No        | LonWorks                    |
| SE7605B5045W | Wireless roof top controller    | No         | Yes        | 2H/2C            | No       | No        | Wireless                    |
| SE7605B5545  | Stand-alone roof top controller | No         | Yes        | 2H/2C            | No       | Yes       | Stand-alone (network ready) |
| SE7605B5545B | BACnet roof top controller      | No         | Yes        | 2H/2C            | No       | Yes       | BACnet                      |
| SE7605B5545E | LON roof top controller         | No         | Yes        | 2H/2C            | No       | Yes       | LonWorks                    |
| SE7605B5545W | Wireless roof top controller    | No         | Yes        | 2H/2C            | No       | Yes       | Wireless                    |
| SE7607B5045  | Stand-alone roof top controller | No         | No         | 2H/2C            | Yes      | No        | Stand-alone (network ready) |
| SE7607B5045B | BACnet roof top controller      | No         | No         | 2H/2C            | Yes      | No        | BACnet                      |
| SE7607B5045E | LON roof top controller         | No         | No         | 2H/2C            | Yes      | No        | LonWorks                    |
| SE7607B5045W | Wireless roof top controller    | No         | No         | 2H/2C            | Yes      | No        | Wireless                    |
| SE7607B5545  | Stand-alone roof top controller | No         | No         | 2H/2C            | Yes      | Yes       | Stand-alone (network ready) |
| SE7607B5545B | BACnet roof top controller      | No         | No         | 2H/2C            | Yes      | Yes       | BACnet                      |
| SE7607B5545E | LON roof top controller         | No         | No         | 2H/2C            | Yes      | Yes       | LonWorks                    |
| SE7607B5545W | Wireless roof top controller    | No         | No         | 2H/2C            | Yes      | Yes       | Wireless                    |

SE7600A and SE7600B continues >>

## SE7600A and SE7600B | Roof top controllers



| Part Number  | Description                     | Scheduling | Economiser | Heat/Cool Stages | Humidity | PIR Cover | Communication               |
|--------------|---------------------------------|------------|------------|------------------|----------|-----------|-----------------------------|
| SE7652A5045  | Stand-alone roof top controller | Yes        | No         | 1H/1C            | No       | No        | Stand-alone (network ready) |
| SE7652A5045B | BACnet roof top controller      | Yes        | No         | 1H/1C            | No       | No        | BACnet                      |
| SE7652A5045E | LON roof top controller         | Yes        | No         | 1H/1C            | No       | No        | LonWorks                    |
| SE7652A5045W | Wireless roof top controller    | Yes        | No         | 1H/1C            | No       | No        | Wireless                    |
| SE7652A5545  | Stand-alone roof top controller | Yes        | No         | 1H/1C            | No       | Yes       | Stand-alone (network ready) |
| SE7652A5545B | BACnet roof top controller      | Yes        | No         | 1H/1C            | No       | Yes       | BACnet                      |
| SE7652A5545E | LON roof top controller         | Yes        | No         | 1H/1C            | No       | Yes       | LonWorks                    |
| SE7652A5545W | Wireless roof top controller    | Yes        | No         | 1H/1C            | No       | Yes       | Wireless                    |
| SE7652B5045  | Stand-alone roof top controller | Yes        | No         | 2H/2C            | No       | No        | Stand-alone (network ready) |
| SE7652B5045B | BACnet roof top controller      | Yes        | No         | 2H/2C            | No       | No        | BACnet                      |
| SE7652B5045E | LON roof top controller         | Yes        | No         | 2H/2C            | No       | No        | LonWorks                    |
| SE7652B5045W | Wireless roof top controller    | Yes        | No         | 2H/2C            | No       | No        | Wireless                    |
| SE7652B5545  | Stand-alone roof top controller | Yes        | No         | 2H/2C            | No       | Yes       | Stand-alone (network ready) |
| SE7652B5545B | BACnet roof top controller      | Yes        | No         | 2H/2C            | No       | Yes       | BACnet                      |
| SE7652B5545E | LON roof top controller         | Yes        | No         | 2H/2C            | No       | Yes       | LonWorks                    |
| SE7652B5545W | Wireless roof top controller    | Yes        | No         | 2H/2C            | No       | Yes       | Wireless                    |
| SE7656B5045  | Stand-alone roof top controller | Yes        | Yes        | 2H/2C            | No       | No        | Stand-alone (network ready) |
| SE7656B5045B | BACnet roof top controller      | Yes        | Yes        | 2H/2C            | No       | No        | BACnet                      |
| SE7656B5045E | LON roof top controller         | Yes        | Yes        | 2H/2C            | No       | No        | LonWorks                    |
| SE7656B5045W | Wireless roof top controller    | Yes        | Yes        | 2H/2C            | No       | No        | Wireless                    |
| SE7656B5545  | Stand-alone roof top controller | Yes        | Yes        | 2H/2C            | No       | Yes       | Stand-alone (network ready) |
| SE7656B5545B | BACnet roof top controller      | Yes        | Yes        | 2H/2C            | No       | Yes       | BACnet                      |
| SE7656B5545E | LON roof top controller         | Yes        | Yes        | 2H/2C            | No       | Yes       | LonWorks                    |
| SE7656B5545W | Wireless roof top controller    | Yes        | Yes        | 2H/2C            | No       | Yes       | Wireless                    |
| SE7657B5045  | Stand-alone roof top controller | Yes        | No         | 2H/2C            | Yes      | No        | Stand-alone (network ready) |
| SE7657B5045B | BACnet roof top controller      | Yes        | No         | 2H/2C            | Yes      | No        | BACnet                      |
| SE7657B5045E | LON roof top controller         | Yes        | No         | 2H/2C            | Yes      | No        | LonWorks                    |
| SE7657B5045W | Wireless roof top controller    | Yes        | No         | 2H/2C            | Yes      | No        | Wireless                    |
| SE7657B5545  | Stand-alone roof top controller | Yes        | No         | 2H/2C            | Yes      | Yes       | Stand-alone (network ready) |
| SE7657B5545B | BACnet roof top controller      | Yes        | No         | 2H/2C            | Yes      | Yes       | BACnet                      |
| SE7657B5545E | LON roof top controller         | Yes        | No         | 2H/2C            | Yes      | Yes       | LonWorks                    |
| SE7657B5545W | Wireless roof top controller    | Yes        | No         | 2H/2C            | Yes      | Yes       | Wireless                    |

Schneider Electric SE7000 Series room controllers offer simple yet elegant high-performance product features that deliver proven solutions to existing mid-market opportunities with the added benefit of providing significant energy savings.

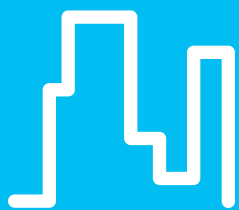

Building



Efficient control



Green energy

## SE7600H | Heat pump controllers

Primarily designed for use in small to mid-sized commercial building applications, SE7600 Series room controllers can be installed in any building using a standard roof top or heat pump unit with a requirement for advanced fresh air control. Capable of controlling economiser-free cooling and demand-based ventilation strategies, the SE7600 Series provides fresh air measurement input right out of the box.



| Part Number  | Description                      | Scheduling | Heat/Cool Stages | PIR Cover | Communication               |
|--------------|----------------------------------|------------|------------------|-----------|-----------------------------|
| SE7600H5045  | Stand-alone heat pump controller | No         | 3H/2C            | No        | Stand-alone (network ready) |
| SE7600H5045B | BACnet heat pump controller      | No         | 3H/2C            | No        | BACnet                      |
| SE7600H5045E | LON heat pump controller         | No         | 3H/2C            | No        | LonWorks                    |
| SE7600H5045W | Wireless heat pump controller    | No         | 3H/2C            | No        | Wireless                    |
| SE7600H5545  | Stand-alone heat pump controller | No         | 3H/2C            | Yes       | Stand-alone (network ready) |
| SE7600H5545B | BACnet heat pump controller      | No         | 3H/2C            | Yes       | BACnet                      |
| SE7600H5545E | LON heat pump controller         | No         | 3H/2C            | Yes       | LonWorks                    |
| SE7600H5545W | Wireless heat pump controller    | No         | 3H/2C            | Yes       | Wireless                    |
| SE7652H5045  | Stand-alone heat pump controller | Yes        | 3H/2C            | No        | Stand-alone (network ready) |
| SE7652H5045B | BACnet heat pump controller      | Yes        | 3H/2C            | No        | BACnet                      |
| SE7652H5045E | LON heat pump controller         | Yes        | 3H/2C            | No        | LonWorks                    |
| SE7652H5045W | Wireless heat pump controller    | Yes        | 3H/2C            | No        | Wireless                    |
| SE7652H5545  | Stand-alone heat pump controller | Yes        | 3H/2C            | Yes       | Stand-alone (network ready) |
| SE7652H5545B | BACnet heat pump controller      | Yes        | 3H/2C            | Yes       | BACnet                      |
| SE7652H5545E | LON heat pump controller         | Yes        | 3H/2C            | Yes       | LonWorks                    |
| SE7652H5545W | Wireless heat pump controller    | Yes        | 3H/2C            | Yes       | Wireless                    |

## SE7600E | Indoor air quality controllers - Coming soon!

Indoor air quality is increasingly becoming a major concern to businesses, building managers, tenants, and employees because of its direct impact on the comfort, well-being, and productivity of the building's occupants. The SE7600E indoor air quality controller, along with a CO2 sensor, is a cost-effective solution capable of controlling economiser-free cooling and demand-based ventilation strategies, while providing a fresh air measurement input. When connected to a building automation system, the controller can monitor and verify the CO2 and fresh air levels, ensuring optimal air quality and energy efficiency.



| Part Number  | Description                | Scheduling | Heat/Cool Stages | PIR Cover | Communication               |
|--------------|----------------------------|------------|------------------|-----------|-----------------------------|
| SE7606E5045  | Stand-alone IAQ controller | No         | 2H/2C            | No        | Stand-alone (network ready) |
| SE7606E5045B | BACnet IAQ controller      | No         | 2H/2C            | No        | BACnet                      |
| SE7606E5045W | Wireless IAQ controller    | No         | 2H/2C            | No        | Wireless                    |
| SE7606E5545  | Stand-alone IAQ controller | No         | 2H/2C            | Yes       | Stand-alone (network ready) |
| SE7606E5545B | BACnet IAQ controller      | No         | 2H/2C            | Yes       | BACnet                      |
| SE7606E5545W | Wireless IAQ controller    | No         | 2H/2C            | Yes       | Wireless                    |
| SE7656E5045  | Stand-alone IAQ controller | Yes        | 2H/2C            | No        | Stand-alone (network ready) |
| SE7656E5045B | BACnet IAQ controller      | Yes        | 2H/2C            | No        | BACnet                      |
| SE7656E5045W | Wireless IAQ controller    | Yes        | 2H/2C            | No        | Wireless                    |
| SE7656E5545  | Stand-alone IAQ controller | Yes        | 2H/2C            | Yes       | Stand-alone (network ready) |
| SE7656E5545B | BACnet IAQ controller      | Yes        | 2H/2C            | Yes       | BACnet                      |
| SE7656E5545W | Wireless IAQ controller    | Yes        | 2H/2C            | Yes       | Wireless                    |

## SE7600F | Roof top controllers for modulating heat - Coming soon!

The new SE7600F roof top terminal equipment controller with modulating heat can make your building more comfortable while still meeting the ventilation codes for minimum building fresh air requirements. The easy-to-install SE7600F includes modulating heat functionality, which allows the addition of an extra supply air temperature control loop to better control and condition the supply air levels for a more comfortable occupant environment.



| Part Number  | Description                            | Scheduling | Heat/Cool Stages | PIR Cover | Communication               |
|--------------|--|------------|------------------|-----------|-----------------------------|
| SE7600F5045  | Stand-alone modulating heat controller | No         | 1H (analogue)/2C | No        | Stand-alone (network ready) |
| SE7600F5045B | BACnet modulating heat controller      | No         | 1H (analogue)/2C | No        | BACnet                      |
| SE7600F5045W | Wireless modulating heat controller    | No         | 1H (analogue)/2C | No        | Wireless                    |
| SE7600F5545  | Stand-alone modulating heat controller | No         | 1H (analogue)/2C | Yes       | Stand-alone (network ready) |
| SE7600F5545B | BACnet modulating heat controller      | No         | 1H (analogue)/2C | Yes       | BACnet                      |
| SE7600F5545W | Wireless modulating heat controller    | No         | 1H (analogue)/2C | Yes       | Wireless                    |
| SE7652F5045  | Stand-alone modulating heat controller | Yes        | 1H (analogue)/2C | No        | Stand-alone (network ready) |
| SE7652F5045B | BACnet modulating heat controller      | Yes        | 1H (analogue)/2C | No        | BACnet                      |
| SE7652F5045W | Wireless modulating heat controller    | Yes        | 1H (analogue)/2C | No        | Wireless                    |
| SE7652F5545  | Stand-alone modulating heat controller | Yes        | 1H (analogue)/2C | Yes       | Stand-alone (network ready) |
| SE7652F5545B | BACnet modulating heat controller      | Yes        | 1H (analogue)/2C | Yes       | BACnet                      |
| SE7652F5545W | Wireless modulating heat controller    | Yes        | 1H (analogue)/2C | Yes       | Wireless                    |

### SE7600 Series ordering

SE76           45  

#### Programmability:

- 0 = No local scheduling / non programmable
- 5 = Local scheduling / prorammmable

#### PIR options:

- 50 = PIR ready but PIR cover not included
- 55 = Factory assembled with PIR cover

#### Communication options:

- B = BACnet® MS/TP
- E = Echelon®
- W = Zigbee® wireless
- = Network ready

#### Economiser / Humidity control:

- 0 = No local scheduling / Non programmable
- 2 = Local scheduling / Programmable
- 5 = With economiser no local scheduling / Non programmable
- 6 = With economiser local scheduling / Programmable
- 7 = With Humidification / Dehumidification control

#### Compatibility:

- A = 1H / 1C roof top unit applications
- B = 2H / 2C roof top unit applications
- E = 2H / 2C IAQ applications
- F = 1H / 2C modulating heat applications
- H = 3H / 2C heat pump applications
- W = 2H / 2C water source heat pump applications

#### Example:

##### SE7652H5045E

- Roof Top Controller
- No local scheduling or programming
- 2H / 2C Application
- PIR Ready
- Zigbee® wireless communication

\* Some part number configurations may not be available. Please refer to the tables for available versions.



## SE7600W | Water source heat pump controllers - Coming soon!

The new SE7600W water source heat pump controller (with dedicated dehumidification sequences) provides exceptional control of water source heat pumps for commercial buildings. Common indoor air quality issues such as mold, mildew, condensation, poor occupant comfort, and overall building health can be effectively resolved in an energy-efficient manner. Simple to install and commission, this wall-mounted device monitors water temperature, as well as other points, offering added value without the additional costs related to more complex systems.



| Part Number  | Description                                   | Scheduling | Heat/Cool Stages | PIR Cover | Communication               |
|--------------|---|------------|------------------|-----------|-----------------------------|
| SE7600W5045  | Stand-alone water source heat pump controller | No         | 2H/2C            | No        | Stand-alone (network ready) |
| SE7600W5045B | BACnet water source heat pump controller      | No         | 2H/2C            | No        | BACnet                      |
| SE7600W5045W | Wireless water source heat pump controller    | No         | 2H/2C            | No        | Wireless                    |
| SE7600W5545  | Stand-alone water source heat pump controller | No         | 2H/2C            | Yes       | Stand-alone (network ready) |
| SE7600W5545B | BACnet water source heat pump controller      | No         | 2H/2C            | Yes       | BACnet                      |
| SE7600W5545W | Wireless water source heat pump controller    | No         | 2H/2C            | Yes       | Wireless                    |
| SE7652W5045  | Stand-alone water source heat pump controller | Yes        | 2H/2C            | No        | Stand-alone (network ready) |
| SE7652W5045B | BACnet water source heat pump controller      | Yes        | 2H/2C            | No        | BACnet                      |
| SE7652W5045W | Wireless water source heat pump controller    | Yes        | 2H/2C            | No        | Wireless                    |
| SE7652W5545  | Stand-alone water source heat pump controller | Yes        | 2H/2C            | Yes       | Stand-alone (network ready) |
| SE7652W5545B | BACnet water source heat pump controller      | Yes        | 2H/2C            | Yes       | BACnet                      |
| SE7652W5545W | Wireless water source heat pump controller    | Yes        | 2H/2C            | Yes       | Wireless                    |

SE7682S | Wireless central manager - Coming soon!

With wireless central managers customers benefit from simple yet flexible management of multiple equipment controllers from one convenient location. Facility managers can now efficiently administer parameters for up to 60 room controllers with one wireless central manager, saving both time and effort.

| Wireless central manager |                          |               |
|--------------------------|--------------------------|---------------|
| Part Number              | Description              | Communication |
| SE7682S5045W             | Wireless central manager | Wireless      |



SEZ7260 Series ordering

SEZ7260

45

Example:  
SEZ7260F5545B

- Zoning System Controller
- Analogue outputs
- Factory assembled PIR cover
- BACnet® MS/TP communication

PIR options:

- 50 = PIR ready but PIR cover not included
- 55 = Factory assembled with PIR cover

Control Output Type:

- C = Floating or on/off digital control outputs
- F = Analogue 0 - 10 VDC control outputs

Communication options:

- B = BACnet® MS/TP
- W = Zigbee® wireless

\* Some part number configurations may not be available. Please refer to the tables for available versions.

SEZ7656 Series ordering

SEZ7656

45

Example:  
SE7656E5045W

- Zoning System Controller
- 2H / 2C IAQ application
- PIR Ready
- Zigbee® wireless communication

PIR options:

- 50 = PIR ready but PIR cover not included
- 55 = Factory assembled with PIR cover

Communication options:

- E = 2H / 2C IAQ applications
- F = 1H / 2C modulating heat applications
- H = 3H / 2C heat pump applications
- R = 2H / 2C roof top applications
- W = 2H / 2C water source heat pump applications

Communication options:

- B = BACnet® MS/TP
- W = Zigbee® wireless

\* Some part number configurations may not be available. Please refer to the tables for available versions.

## SEZ7000 | Commercial zoning systems - Coming soon!

The SEZ commercial zoning system has been specifically designed to bring a simple scalable solution to mid-market commercial applications without the cost associated with a typical DDC zoning system. Models include roof top and heat pump units controlling analogue heat, CO2 levels, and indoor air quality. Zoning controllers that provide floating and analogue damper control are also available. A single central controller unit can support up to 64 individual zone controllers.

All zoning system controllers can be ordered with an on-board passive infrared (PIR) occupancy sensor cover that allows for advanced occupancy strategies, enabling greater energy savings to zones during scheduled events when no occupants are present.

### Commercial zoning system - zone controllers



| Part Number   | Description                | Output             | PIR Cover | Communication |
|---------------|----------------------------|--------------------|-----------|---------------|
| SEZ7260C5045B | BACnet zoning controller   | Floating or on/off | No        | BACnet        |
| SEZ7260C5045W | Wireless zoning controller | Floating or on/off | No        | Wireless      |
| SEZ7260C5545B | BACnet zoning controller   | Floating or on/off | Yes       | BACnet        |
| SEZ7260C5545W | Wireless zoning controller | Floating or on/off | Yes       | Wireless      |
| SEZ7260F5045B | BACnet zoning controller   | 0 -10 V            | No        | BACnet        |
| SEZ7260F5045W | Wireless zoning controller | 0 -10 V            | No        | Wireless      |
| SEZ7260F5545B | BACnet zoning controller   | 0 -10 V            | Yes       | BACnet        |
| SEZ7260F5545W | Wireless zoning controller | 0 -10 V            | Yes       | Wireless      |

### Commercial zoning system - roof top controllers



| Part Number   | Description                  | IAQ | Economiser | Modulating Heat | Communication |
|---------------|------------------------------|-----|------------|-----------------|---------------|
| SEZ7656E5045B | BACnet roof top controller   | Yes | Yes        | No              | BACnet        |
| SEZ7656E5045W | Wireless roof top controller | Yes | Yes        | No              | Wireless      |
| SEZ7656F5045B | BACnet roof top controller   | No  | No         | Yes             | BACnet        |
| SEZ7656F5045W | Wireless roof top controller | No  | No         | Yes             | Wireless      |
| SEZ7656R5045B | BACnet roof top controller   | No  | No         | No              | BACnet        |
| SEZ7656R5045W | Wireless roof top controller | No  | No         | No              | Wireless      |

### Commercial zoning system - heat pump controllers



| Part Number   | Description                        | Water Source | Communication |
|---------------|------------------------------------|--------------|---------------|
| SEZ7656H5045B | Bacnet heat pump unit controller   | No           | BACnet        |
| SEZ7656H5045W | Wireless heat pump unit controller | No           | Wireless      |
| SEZ7656W5045B | Bacnet heat pump controller        | Yes          | BACnet        |
| SEZ7656W5045W | Wireless heat pump controller      | Yes          | Wireless      |

# Wireless accessories and specifications

## Wireless integration

The wireless versions of the SE7000 provide a simple yet powerful solution which targets such retrofit installations where running new communication wiring is cost prohibitive. The wireless room controllers can dramatically reduce project installation costs by re-using the existing control wiring already in place between older electronic thermostats and the terminal equipment. No new network wires are required since the controllers rely on a fully integrated ZigBee® wireless mesh network infrastructure. Connecting wireless SE7000 series devices into an iBMS network is made easy with two integration methods, either via a gateway or a wireless serial adapter.

## Wireless gateway

The VWG-50-5045 gateway connects up to 50 wireless SE7000 devices to an iBMS network using a BACnet® MS/TP or BACnet® IP connection.

|  | Part Number    | Description                                       |
|---|----------------|---|
|   | VWG-50-5045    | Wireless gateway*                                 |
|   | VWG-PS-AC-1045 | Universal AC power supply (100-240 VAC to 15 VDC) |

\* The VWG-50-5045 does not come with a power supply. A VWG-PS power supply will be required for each gateway.

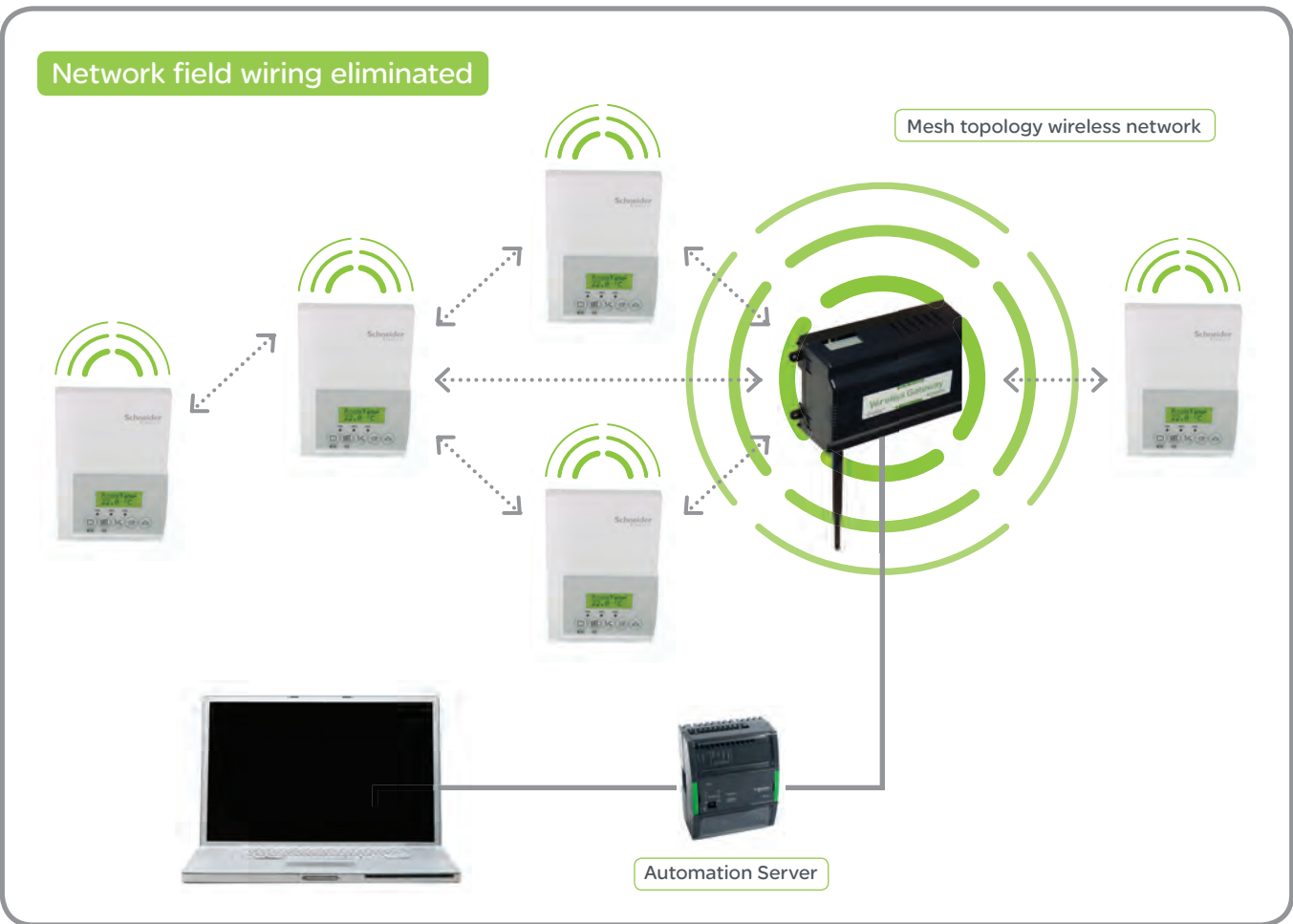

# Wireless serial adapters

Connecting wireless SE7000 devices to an iBMS network can be simplified by adding a wireless module to existing network controllers. This is a more cost-effective solution.

|  | Part Number  | Description   |
|--|--------------|---|
|  | VWG-APP-1045 | Wireless serial adapter for TAC I/A Series JACE-200/600/700   |
|  | VWG-EPP-1045 | Wireless serial adapter for Andover Continuum ACX/bCX <sup>1</sup> or TAC I/A Series ENC-520 <sup>2</sup> |

- 1 – For Andover Continuum ACX with RS-485, an external RS-232 to RS-485 adapter is required.  
 2 – For TAC I/A Series ENC-520 applications, a CBL-xxx is required.

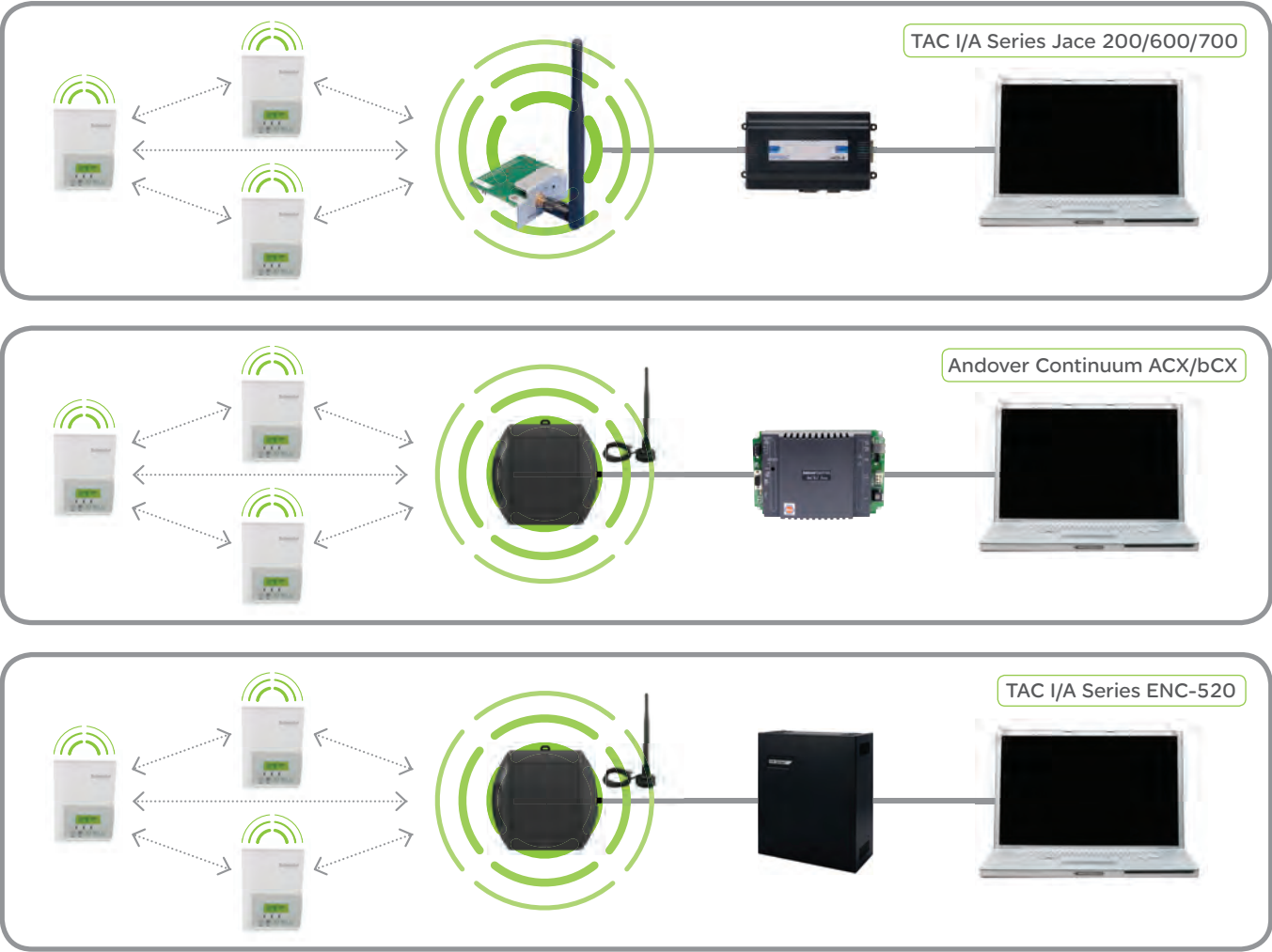

# Wireless accessories

|  | Part Number   | Description          |
|--|---------------|----------------------|
|  | VRP5000W1045W | Wireless repeater    |
|  | VST5000W5045W | Wireless survey tool |
|  | VWG-BB-1045   | Battery backup       |
|  | VWG-RA-1045   | Remote antenna       |
|  | VWG-WA-1045   | Whip antenna         |



## Wireless specs

## Wireless gateway



| Platform         |  |
|------------------|--|
|                  | PowerPC 405EP 250 MHz processor  |
|                  | 64MB SDRAM & 64 MB serial flash  |
|                  | 128 KB static RAM  |
|                  | Battery Backup - 5 minutes typical - shutdown begins within 10 seconds                         |
|                  | Real-time clock - 3 month backup max via battery   |
| Operating system |  |
|                  | QNX RTOS   |
|                  | IBM J9 JVM Java Virtual Machine  |
|                  | NiagaraAX  |
| Communications   |  |
|                  | 2 Ethernet Ports – 10/100 Mbps (RJ-45 Connectors)  |
|                  | 1 RS 232 Port (9 pin D-shell connector)  |
|                  | 1 RS 485 non isolated port (3 Screw connector on baseboard)                                    |
| Environment      |  |
|                  | Operating temperature range: 0° to 50°C (32°F to 122°F)  |
|                  | Storage temperature range: 0° to 60°C (32°F to 140°F)  |
|                  | Relative humidity range: 5% to 95%, non-condensing   |
| Agency listings  |  |
|                  | UL 916, C-UL listed to Canadian Standards Association  |
|                  | (CSA) C22.2 No. 205-M1983 “signal equipment”   |
|                  | CE, FCC part 15 Class A  |
|                  | C-tick (Australia)   |
| Power supply     |  |
|                  | VWG-PS-DC 24 VAC to 15 VDC panel mounted power supply for VWG                                  |
|                  | VWG-PS-AC 120 VAC to 15 VDC power supply for VWG with cord                                     |
| Chassis          |  |
|                  | Construction: Plastic, din rail or screw mount chassis, plastic cover                          |
|                  | Cooling: Internal air convection   |
|                  | Dimensions: 160.4mm (6.313") W x 122.4mm (4.820") H (including connectors) x 61.9mm (2.438") D |

## Accessories and specifications

From wired to wireless systems, remote sensors to communication boards and covers, SE7000 Series room controllers can be tailored for any application-specific needs.

### Covers

SE7000 Series room controllers are compatible with passive infrared cover accessories. Room controllers equipped with a passive infrared cover provide advanced active occupancy logic, which will automatically switch occupancy levels from “occupied” to “stand-by” and “unoccupied” as appropriate. This built-in intelligence provides energy savings during occupied hours without sacrificing occupant comfort.



| Part Number        | Description  | Compatibility                 |
|--------------------|--|-------------------------------|
| COV-PIR-ZN-5045    | PIR cover for zoning controllers                   | SE7200 models                 |
| COV-PIR-FCU-C-5045 | PIR cover for fan coil controllers (commercial)    | SE7300 models (commercial)    |
| COV-PIR-FCU-L-5045 | PIR cover for fan coil controllers (hotel/lodging) | SE7300 models (hotel/lodging) |
| COV-PIR-RTUHP-5045 | PIR cover for roof top/heat pump controllers       | SE7600 models                 |

### Remote sensors

Our discreet line of wall mount room sensors is used for advanced room temperature sensing. Each model is equipped with three thermistors and two dip switches for various averaging combinations, with a temporary override key and an occupancy LED available in the advanced model.



| Part Number | Description            |
|-------------|------------------------|
| SE3010W1045 | Room sensor            |
| SE3020W1045 | Room sensor w/override |



### Communication boards

SE7000 Series room controllers are network ready, designed to accept the addition of communication. With a network card available for field upgrade, your system can be networked to an integrated building management system for the most advanced control and functionality.



| Part Number   | Description                 | Compatibility                                  |
|---------------|-----------------------------|--|
| VCM7000V5045W | Wireless communication card | SE7000 Series room controllers                 |
| VCM7300V5045B | BACnet communication card   | SE7200/SE7300 Series room controllers          |
| VCM7300V5045E | LON communication card      | SE7200/SE7300 Series room controllers          |
| VCM7600V5045B | BACnet communication card   | SE7600 Series room controllers                 |
| VCM7600V5045E | LON communication card      | SE7600 Series room controllers                 |
| VCM7607V5045B | BACnet communication card   | SE76x7 room controllers (with humidity option) |
| VCM7607V5045E | LON communication card      | SE76x7 room controllers (with humidity option) |

## Specs

|                                  | SE7200  | SE7300   | SE7600  |
|----------------------------------|---|--|---|
|                                  |  |  |  |
| Agency approval                  | CE, C-Tick, UL  | CE, C-Tick, UL   | CE, C-Tick, UL  |
| Weight                           | 0.34 kg (0.75 lb)   | 0.34 kg (0.75 lb)  | 0.34 kg (0.75 lb)   |
| Dimensions (H x W x D)           |   |  |   |
| Non-PIR model                    | 125mm x 87mm x 30mm<br>(4.92" x 3.41" x 1.16")                                    | 125mm x 87mm x 30mm<br>(4.92" x 3.41" x 1.16")                                     | 125mm x 87mm x 30mm<br>(4.92" x 3.41" x 1.16")                                      |
| PIR model                        | 125mm x 87mm x 38mm<br>(4.92" x 3.41" x 1.47")                                    | 125mm x 87mm x 38mm<br>(4.92" x 3.41" x 1.47")                                     | 125mm x 87mm x 38mm<br>(4.92" x 3.41" x 1.47")                                      |
| Power supply                     | 10-30 VAC (50/60Hz)   | 10-30 VAC (50/60Hz)  | 10-30 VAC (50/60Hz)   |
| Outputs                          |   |  |   |
| Analogue                         | 0-10 VDC  | 0-10 VDC   | 0-10 VDC  |
| Triac                            | 30 VAC, 1 Amp   | 30 VAC, 1 Amp  | 30 VAC, 1 Amp   |
| Operating conditions             | 0° - 50°C (32° - 122°F)<br>0 - 95% RH (Non-condensing)                            | 0° - 50°C (32° - 122°F)<br>0 - 95% RH (Non-condensing)                             | 0° - 50°C (32° - 122°F)<br>0 - 95% RH (Non-condensing)                              |
| Temperature sensor type          | 10K Type 2  | 10K Type 2   | 10K Type 2  |
| Temperature sensor accuracy      | ± 0.5 °C (± 0.9 °F) @ 21 °C (70 °F)   | ± 0.5 °C (± 0.9 °F) @ 21 °C (70 °F)  | ± 0.5 °C (± 0.9 °F) @ 21 °C (70 °F)   |
| Humidity sensor type*            | N/A   | Single point calibrated bulk polymer type sensor                                   | Single point calibrated bulk polymer type sensor                                    |
| Humidity sensor read range*      | N/A   | 10 - 90% RH (Non-condensing)   | 10 - 90% RH (Non-condensing)  |
| Humidity sensor accuracy*        | N/A   | ±5% @ 20 - 80% RH (Non-condensing)   | ±5% @ 20 - 80% RH (Non-condensing)  |
| Dehumidification setpoint range* | N/A   | 30 to 95% RH   | 30 to 95% RH  |
| Economiser accuracy*             | N/A   | N/A  | ±3% typical   |

\* Available with selected models.

## Remote sensor specs

|                             |   |
|-----------------------------|---|
|                             |  |
| Operating conditions        | 0°C to 50°C ( 32°F to 122°F )<br>0% to 95% R.H. non-condensing                      |
| Storage conditions          | -30°C to 50°C ( -22°F to 122°F )<br>0% to 95% R.H. non-condensing                   |
| Dimensions                  | 125mm x 87mm x 30mm (4.92" x 3.41" x 1.16")   |
| Approximate shipping weight | 155 grams (0.34 lbs)  |
| Enclosure material          | ABS - FRI [WT1337V] UV stabilised   |



# Energy savings for a healthy bottom line.

Increase the comfort of patients, visitors, and employees while reducing energy consumption with SE7000 Series room controllers.







## Healthcare

Gain full room control of your environment, whether it's a patient room, waiting room, or anywhere within your facility. The SE7000 Series gives you the flexibility to customise and configure based on your needs.



## Retail

Enhance your system operation and efficiency with SE7000 Series room controllers. From a stand-alone device to simplified building management, our room controllers are ideal for your ever-changing location.



## Education

Whether it's a large campus with multiple buildings or a single primary school, the SE7000 Series allows for scalability to control a wide variety of environments through occupied and unoccupied periods.



## Hotels/lodging

Guest comfort meets energy efficiency with the SE7000 Series. The intuitive user interface allows guests to control their own environments while our occupancy sensor and simple programming ensure efficiency.



## Commerical buildings

The SE7000 Series room controllers allow users to save costs and energy while providing a comfortable environment for maximum productivity. The system can be modified on site to match your specific energy conservation needs.